

Collections

Puro

noorth

Research and innovation, the basics of a life project.



Trovare soluzioni per l'arredo bagno è un'attività che impegna la nostra famiglia dal 1976. Un percorso imprenditoriale rivolto ad un mercato sempre più internazionale che ha interpretato il forte cambiamento degli stili di vita e delle abitudini individuali degli ultimi decenni. Con il progetto Noorth, presentato nel 2016 al Salone del Bagno di Milano, ci siamo posti l'obiettivo di esprimere una visione moderna, fondata sulla ricerca e l'innovazione e ispirata ai valori di originalità e coerenza. Ponendoci come obiettivo la qualità in ogni fase del processo, dal design alla produzione, dalla comunicazione ai servizi pre e post vendita, ci impegniamo costantemente per superare gli standard abituali. Dialoghiamo con professionisti diversi per linguaggio e sensibilità per offrire, nel rispetto di un'armonia complessiva, una proposta completa e differenziata. Perché il bagno è un ambiente particolare, con esigenze tecniche specifiche e allo stesso tempo desideri legati alla sensibilità individuale: importante quindi suggerire interpretazioni differenti, modulate su un pensiero comune e coerente. Obiettivo che rende l'ambiente bagno una dimensione ideale per il design e che per noi si traduce nella ricerca costante di un equilibrio tra tecnologia e artigianato, memoria e innovazione, logiche industriali e personalizzazione. La collezione prevede sistemi componibili integrati a una gamma di lavabi e accessori tra le più complete del settore, proposte basate sul rigore e la massima essenzialità formale, affiancate da pezzi iconici, caratterizzati da una forte espressività. Noorth è oggi una realtà definita, il risultato concreto di una precisa visione, un progetto sempre nuovo che ci stimola e ci entusiasma.

Since 1976, our family has been finding solutions for bathroom furniture. An entrepreneurial path aimed at an increasingly international market that has interpreted the radical changes in lifestyles and personal habits of the last decades. With the Noorth project, presented in 2016 at the Salone del Bagno in Milan, we set ourselves the goal of expressing a modern vision based on research and innovation and inspired by the values of originality and consistency. Being aware that quality is a goal to be reached in each single stage of the process, from design to production, from communication to pre- and post-sales services, we constantly work on all fronts to go above and beyond the usual standards. We talk to professionals of different languages and sensitivity to offer a complete and differentiated, but overall harmonious, proposal. As the bathroom is a particular environment, with specific technical needs and at the same time desires linked to individual sensitivity, it is important to suggest different interpretations, built around a common and coherent idea. A goal which makes the bathroom an ideal dimension for design and which, for us, translates into the constant search for balance between technology and craftsmanship, memory and innovation, industrial logics and customisation. The collection includes modular systems supplemented by one of the most complete range of washbasins and accessories in the industry, proposals based on precision and maximum simplicity supported by iconic pieces that stand out by being remarkably expressive. Today, Noorth is a definite reality, the concrete result of a precise vision, a new project that stimulates us and fills us with enthusiasm.

THE STORY OF THE NOORTH COLLECTION THROUGH COSTUMIZED SOLUTIONS,
EVOCATIVE SCENARIOS AND TECHNICAL INSIGHTS.
A VOLUME DEDICATED TO THE CONTEMPORARY BATHROOM,
LINKED TO THE THEME OF EMOTIONS AND WELL-BEING, IN WHICH
THE NOORTH LINE OF APPEARS IN ITS ENTIRETY.

Un approccio sartoriale al progetto bagno per una collezione senza tempo, un viaggio attraverso soluzioni versatili e improntate alla massima funzionalità. Una collezione caratterizzata dall'esclusività dei materiali, dall'equilibrio dei volumi e da approfondite ricerche cromatiche; una proposta esclusiva, dai dettagli sofisticati, in cui la qualità delle lavorazioni, la ricca offerta di soluzioni e la capacità di interpretare le esigenze di contesti differenti permettono di reinterpretare la tradizione della stanza da bagno attraverso un linguaggio nuovo: una perfetta sintesi di stile e progetto. Tra memoria e modernità, tecnologia e artigianalità e tra versatilità compositiva e ricerca formale, la proposta Noorth si sviluppa in 10 collezioni nelle quali l'essenzialità delle linee viene esaltata dalle texture irripetibili dei marmi e delle essenze, dalla nuova ed esclusiva palette dei laccati, dalla trasparenza assoluta dei cristalli e dalla lucentezza dei metalli. Un attento studio sui materiali, sugli abbinamenti cromatici e sulle materie prime, permettono la realizzazione di progetti completi e definiti, offrendo prodotti sempre unici e esclusivi.

A custom approach to bathroom design for a timeless collection, a journey through versatile solutions based on maximum functionality. A collection characterised by the exclusivity of the materials, by the balance of the volumes, and by in-depth research into colour: an exclusive proposal, with sophisticated details, where the work quality, the wide range of solutions, and the ability to interpret the needs of different contexts make for a reinterpretation of the bathroom tradition through a new language: a perfect synthesis of style and design. A perfect blend of memory and modernity, technology and craftsmanship, and with versatile compositions and formal research, the Noorth proposal is structured in 10 collections where simple lines are enhanced by the unique textures of the marble and veneers, the new and exclusive palette of lacquers, the absolute transparency of crystals and the shine of metals. A careful study of materials, colour combinations, and raw materials for the creation of complete and distinctive projects, offering unique and exclusive products.

Puro
design Michele Marcon



Puro

design Michele Marcon

Essential

Rocks

Geometry

Drops

Un design rigoroso fatto di superfici preziose e geometrie perfette, sottolineate dalla lavorazione a 45° di piani e contenitori e dall'assenza della maniglia, sostituita dalla gola. La collezione è arricchita da un inedito fianco laterale in vetro per le basi e dalle colonne a giorno con luce integrata.

A rigorous design made of precious surfaces and perfect structures, underlined by the 45° working of the tops and the units and by the absence of the handle, replaced by the groove. The collection is enriched by an unprecedented glass side panel for the bases and by the open elements with integrated light.



Collezione Puro in laccato Zinco, marmo Bianco Carrara | Puro Collection in lacquered Zinco, Bianco Carrara marble
Top integrato Luto 02 in marmo Bianco Carrara | Luto 02 integrated top in Bianco Carrara marble
Rubinetteria Flow acciaio satinato | Flow satin-finish steel tap
Specchiera Kara retroilluminata Zinco | Kara LED backlight mirror Zinco
Colonna a giorno retroilluminata Zinco | Zinco LED backlight open column
Tappeto Lidi 04 W | Lidi 04 W carpet
202 x 51 cm
79 1/2" x 20 1/8"

Puro 24.01









Collezione Puro in Noce Canaletto | Puro Collection in Noce Canaletto
Top lineare e lavabo Keel 60 in marmo Grafite | Linear top and Keel 60 washbasin in Grafite marble
Rubinetteria Flow PDV nero | Flow tap PDV black
Specchiera Ekos V retroilluminata Quarzo | Ekos V LED backlight mirror Quarzo
Mensole Ljos retroilluminate Quarzo | Ljos LED backlight shelves Quarzo
220 x 51 cm
86 5/8" x 20 1/8"

Puro 24.02



Collezione Puro in Pietra Medea | Puro Collection in Pietra Medea
Top integrato Height 02 in Pietra Medea | Height 02 integrated top in Pietra Medea
Rubinetteria Flow acciaio lucido | Flow polished steel tap
Specchiere Vetra retroilluminate | Vetra LED backlight mirrors
Tappeto Plain 03 B | Plain 03 B carpet
220 x 51 cm
86 5/8" x 20 1/8"

Puro 24.03



Collezione Puro in Pietra Medea | Puro Collection in Pietra Medea
 Top integrato Next 04 in Pietra Medea | Next 04 integrated top in Pietra Medea
 Rubinetteria Flow acciaio satinato | Flow satin-finish steel tap
 Specchiere Vetra retroilluminate | Vetra LED backlight mirrors
 Vasca Oval Cristalplant | Oval Cristalplant bathtub
 Colonne in laccato Fango opaco | Matt Fango lacquered columns
 220 x 51 cm
 86 5/8" x 20 1/8"

Puro 24.04







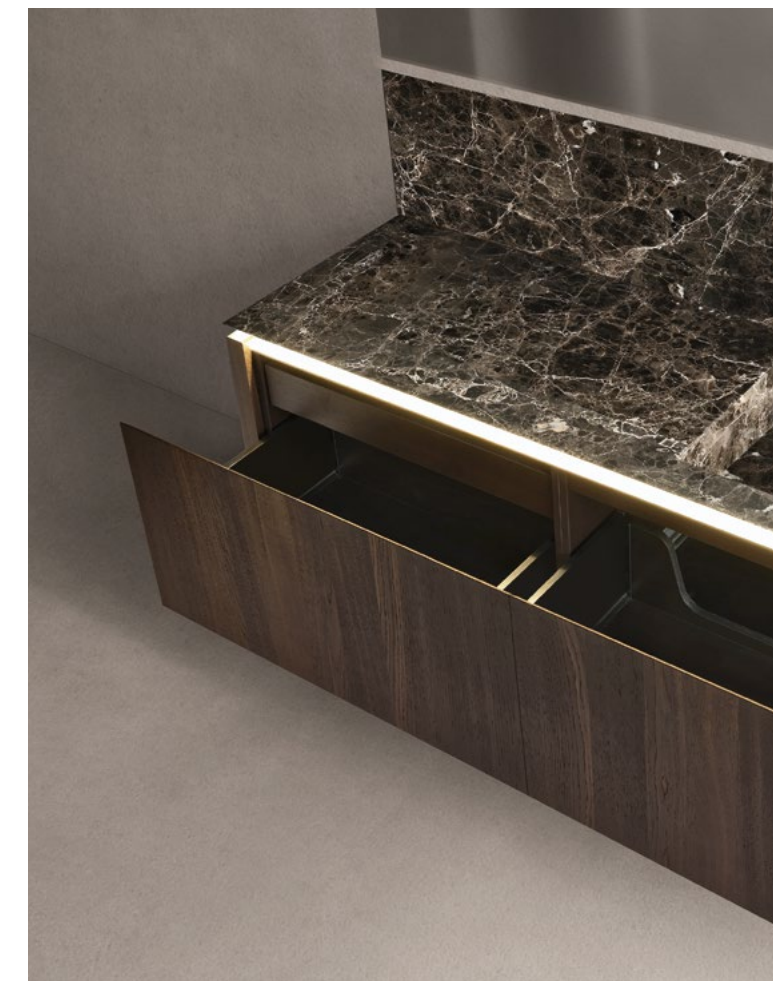

Collezione Puro in Rovere Termocotto | Puro Collection in Rovere Termocotto
 Top integrato Next 05 e alzatina in marmo Emperador | Next 05 integrated top and Emperador marble splashboards
 Rubinetteria Flow acciaio satinato | Flow satin-finish steel tap
 Specchiera Vetra retroilluminata | Vetra LED backlight mirror
 Lampade Moon | Moon lamps
 Portasciugamani Toro Rovere Carbone | Toro Rovere Carbone towel rack
 Tappeto Plain 02 W | Plain 02 W carpet
 220 x 51 cm
 86 5/8" x 20 1/8"

Puro 24.05



Collezione Puro in Noce Canaletto | Puro Collection in Noce Canaletto
 Top integrato Sand 02 MDi Totem Gris | Sand 02 integrated top in MDi Totem Gris
 Rubinetteria Flute acciaio satinato | Flute satin-finish steel tap
 Specchiere Prisma | Prisma mirrors
 Vasca Creek Milltek Solid | Creek bathtub in Milltek Solid
 Colonne e vano a giorno in Noce Canaletto | Columns and open unit in Noce Canaletto
 252 x 56 cm
 99 1/4" x 22

Puro 24.06





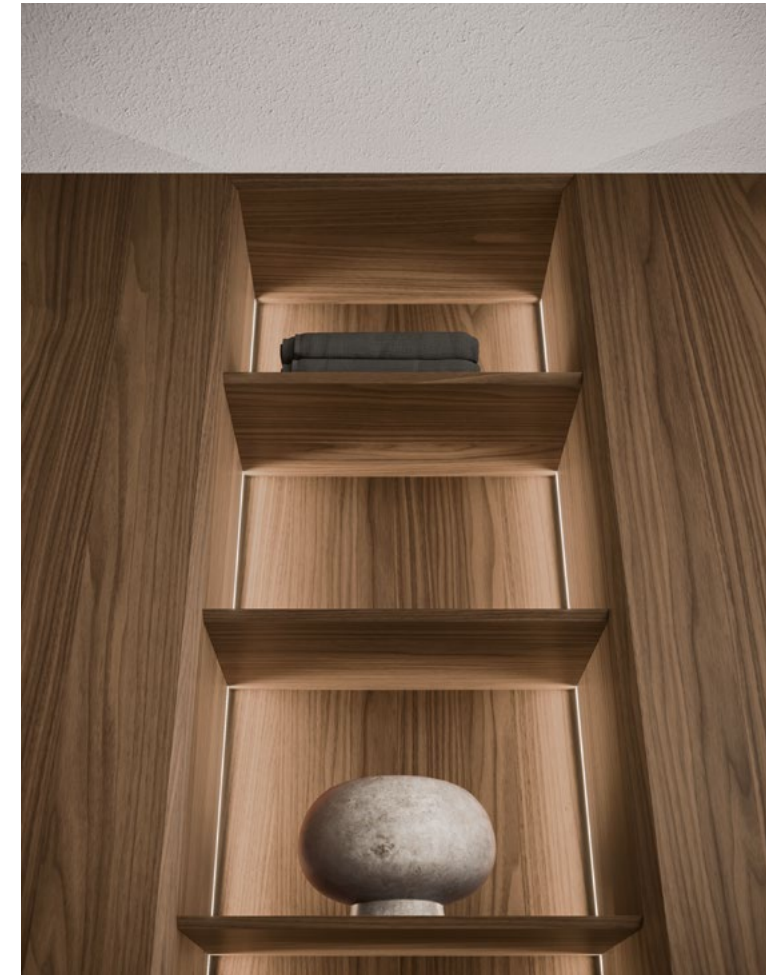



Collezione Puro in Rovere Termocotto | Puro Collection in Rovere Termocotto
 Lavabo Step 63.14 Cristalplant | Step 63.14 Cristalplant washbasin
 Rubinetteria Flow acciaio lucido | Flow polished steel tap
 Specchiera Prisma | Prisma mirror
 Vasca Styling R02_35 Milltek solid, ad incasso con pedana | Styling R02_35 Milltek solid bathtub, recessed with footboard
 Sanitari Senna ceramica bianca opaca | Senna matt white ceramic sanitary ware
 Piatto doccia Sharp Ceramilux | Sharp Ceramilux shower tray
 220 x 56 cm
 86 5/8" x 22



Puro 24.07

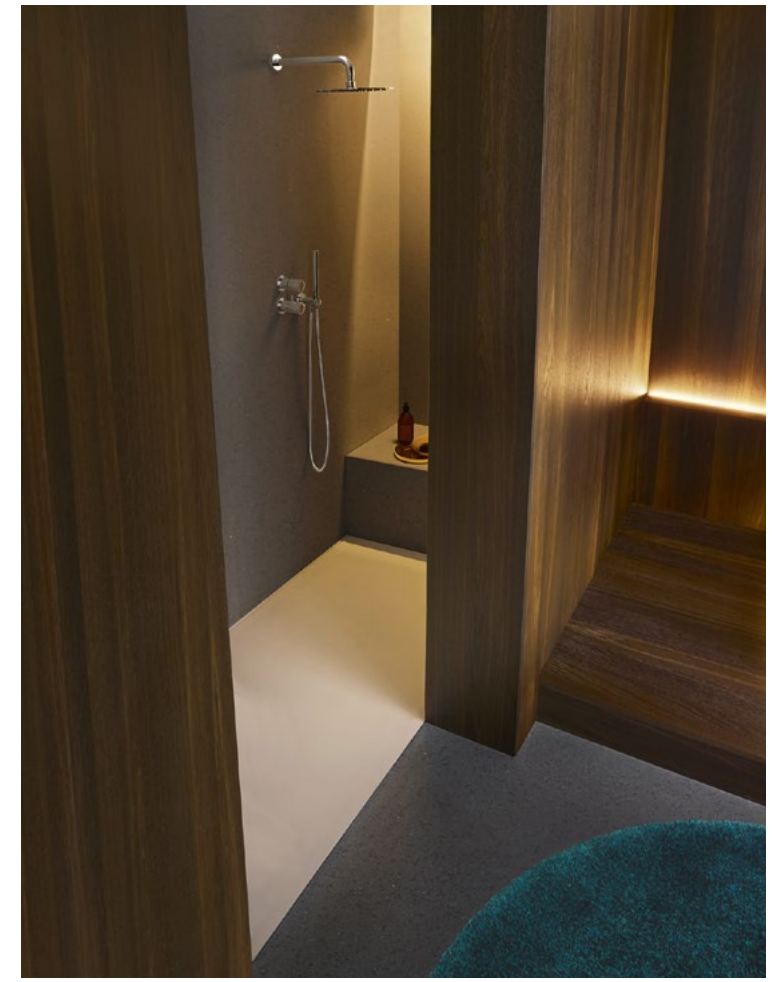

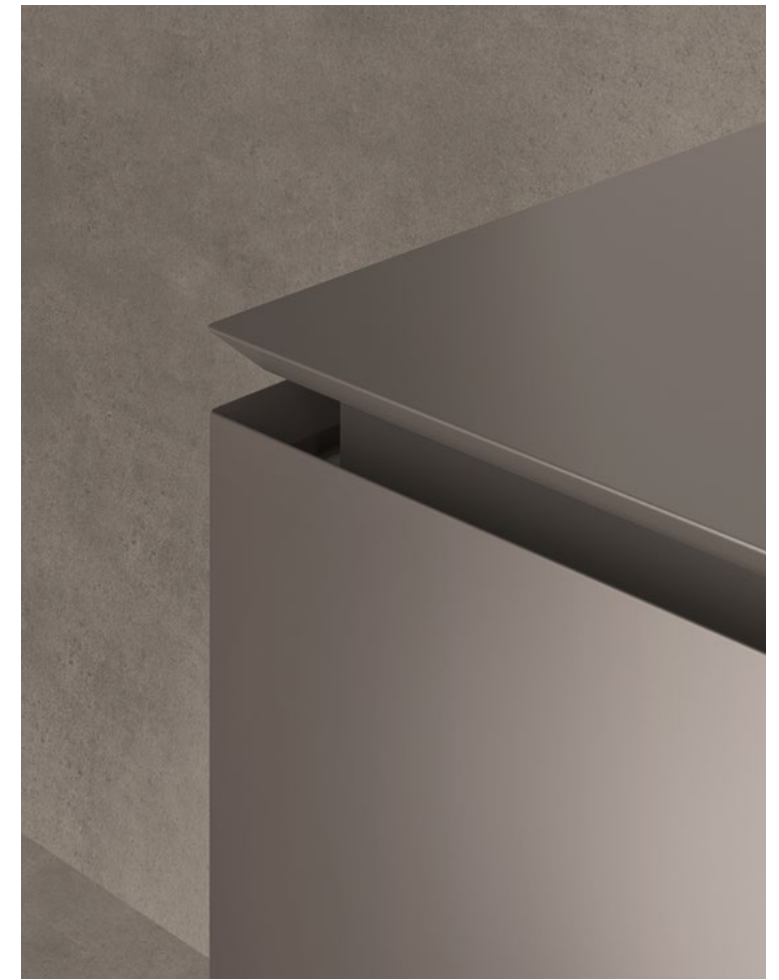

Collezione Puro in laccato Quarzo | Puro Collection in lacquered Quarzo
 Lavabo Loop Cristalplant | Loop Cristalplant washbasin
 Rubinetteria Flow PVD nero | Black Flow PVD tap
 Specchiera Vetra retroilluminata | Vetra LED backlight mirror
 Lampada Linus | Linus lamp
 Mensola Ljos Quarzo | Quarzo Ljos shelf
 Pouf Maki 2 sughero nero | Maki 2 pouf black cork
 Tappeto Lidi 03 B | Lidi 03 B carpet
 229 x 51 cm
 90 1/8" x 20 1/4"

Puro 24.08



Collezione Puro in Rovere Miele | Puro Collection in Rovere Miele
 Lavabo Blend 81 Cristalplant | Blend 81 Cristalplant washbasin
 Rubinetteria Flow acciaio lucido | Flow polished steel tap
 Specchiere Vetra retroilluminate | Vetra LED backlight mirrors
 Portasciugamani Toro Rovere Carbone | Toro Rovere Carbone towel rack
 Tappeto Plain 03 W | Plain 03 W carpet
 202 x 51 cm
 79 1/2" x 20 1/8"

Puro 24.09



Collezione Puro in Rovere Mezza Fiamma | Puro Collection in Rovere Mezza Fiamma
 Top integrato Next 03 in Corian | Next 03 integrated top in Corian
 Rubinetteria Flow acciaio satinato | Flow satin-finish steel tap
 Specchiera Prisma | Prisma mirror
 Parete di sostegno laccato Bianco opaco | Matt Bianco lacquered supporting wall
 Colonne incasso in laccato Bianco opaco | Matt Bianco lacquered recessed columns
 Sanitari Senna ceramica bianca opaca | Senna matt white ceramic sanitary ware
 256 x 56 cm
 100 3/4" x 22"



Puro 24.10





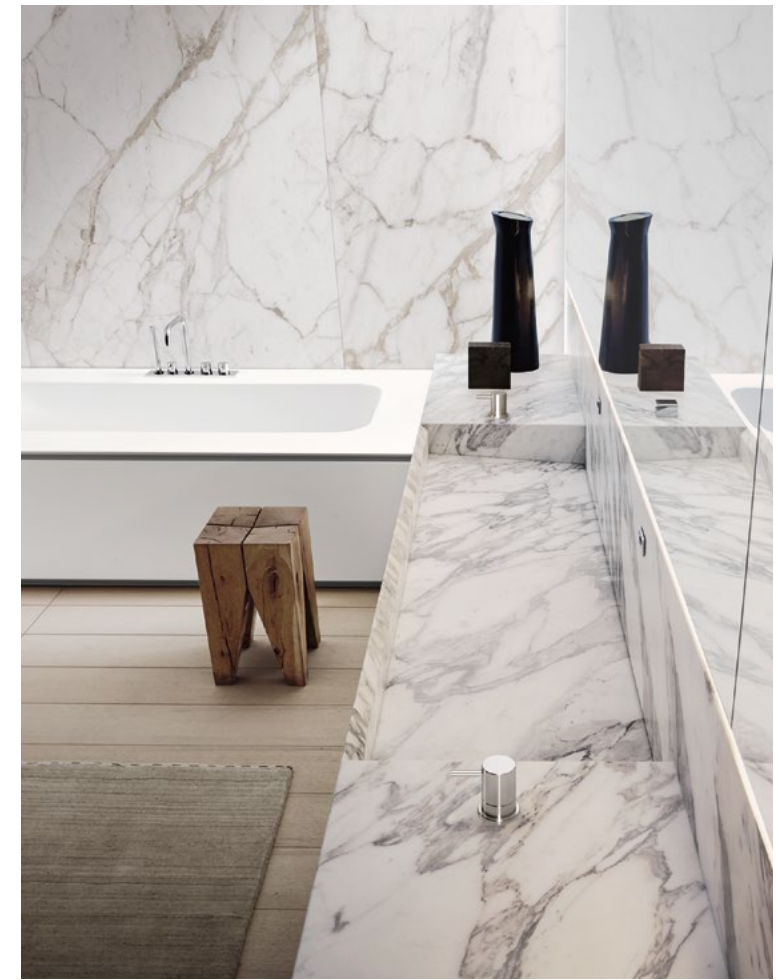

Collezione Puro in laccato Bianco opaco | Puro Collection in matt lacquered Bianco
 Top sospeso Strict 06 marmo Bianco Arabescato con erogatore H2O | Strict 06 suspended top Bianco Arabescato marble with H2O dispenser
 Miscelatore Flow acciaio lucido | Flow polished steel mixer
 Specchiere contenitore semi-incasso | Semi-recessed mirror cabinets
 Vasca Styling R02 in Milltek solid con pannelli di rivestimento in acciaio Bianco opaco
 Styling R02 bathtub in Milltek solid with covering panels in Bianco matt lacquered
 270 x 51 cm
 106 1/4" x 20 1/8"



Puro 24.11





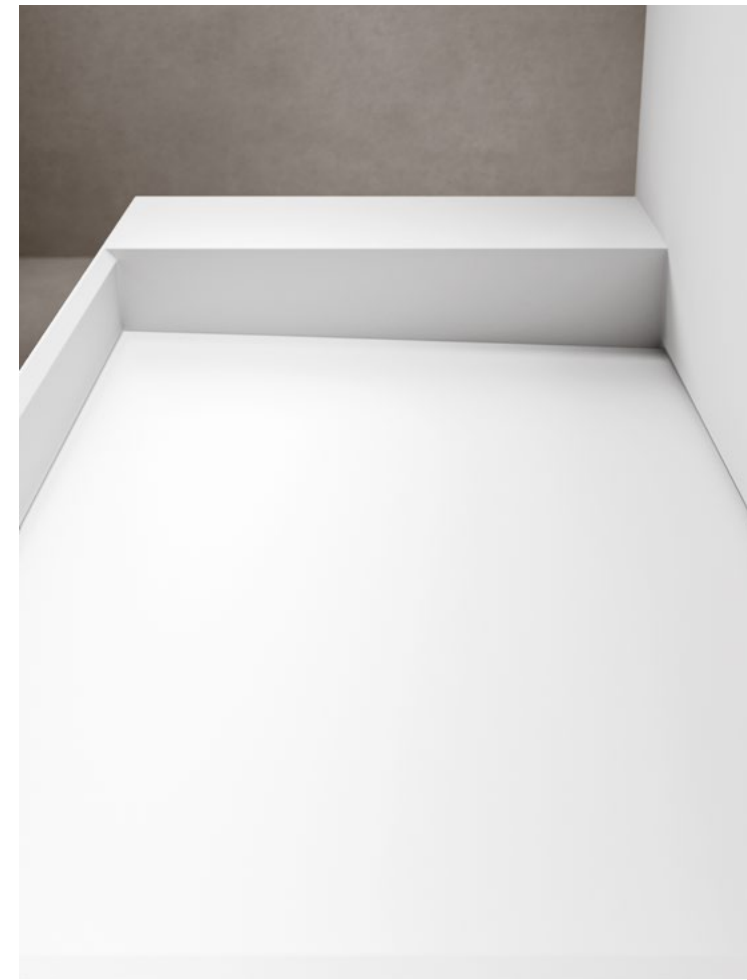

Collezione Puro in laccato Platino | Puro Collection in lacquered Platino
 Top sospeso Strict 02 in Corian con erogatore H2O | Strict 02 wall hung top in Corian with H2O spout
 Miscelatore Flow acciaio lucido | Flow polished steel mixer
 Specchiera Kara retroilluminata Platino | Kara Platino LED backlight mirror
 Tappeto Plain 03 B | Plain 03 B carpet
 202 x 51 cm
 79 1/2" x 20 1/8"

Puro 24.12

Puro 24.01

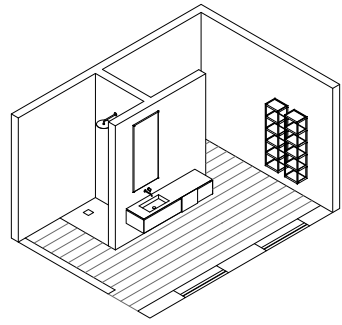

17,80 mq

Composizione Puro L 202 composta da due fianchi di finitura L 2 cod 9718, una base lavabo con cassetto in laccato Zinco L 108 H 35,5 P 51 cod A8750, base con cassetto e frontale in marmo Bianco Carrara L 45 H 35,5 P 51 cod 5392, base con cassetto L 45 H 35,5 P 51 cod 8753. Top integrato Luto 02 in marmo Bianco Carrara L 202 cod 4367 con illuminazione a LED. Specchiera Kara con retroilluminazione a LED L 63 H 120 P 3,5 cod 5234 con profilo alluminio laccato Zinco. Rubinetteria Flow L01 cod 2552 e 2553 in acciaio satinato. Colonne a giorno con ripiani in vetro fumè, struttura in alluminio laccato Zinco e illuminazione a LED L 36 H 153,5 P 26,6 cod 5349. Tappeto Lidi 04 W cod 4207.

Puro W 202 composition composed of two finishing sides W 2 cod 9718, one washbasin base unit with drawer in Zinco finish lacquered W 108 H 35.5 D 51 cod A8750, base with drawer and Bianco Carrara marble front panel W 45 H 35.5 D 51 cod 5392, base unit with drawer W 45 H 35.5 D 51 cod 8753. Luto 02 integrated top in Bianco Carrara marble W 202 cod 4367 with LED lighting. Kara mirror with LED backlighting W 63 H 120 D 3.5 cod 5234 with Zinco finish lacquered aluminium profile. Flow L01 tap cod 2552 and 2553 in satin-finished steel. Open columns with smoked glass shelves, Zinco finish lacquered aluminium frame and LED lighting W 36 H 153,5 D 26.6 cod 5349. Lidi 04 W carpet cod 4207.

Puro 24.02

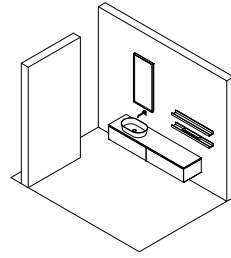

Composizione Puro L 220 composta da due fianchi di finitura L 2 cod 9718, una base lavabo con cassetto L 108 H 35,5 P 51 cod B8750 e una base cassetto L 108 H 35,5 P 51 in Noce Canaletto cod 8757. Top lineare L 220 cod 2952 e lavabo in appoggio Keel 60 cod 2022 in marmo Grafite. Specchiera Ekos con retroilluminazione a LED quattro lati, profilo in alluminio laccato Quarzo L 54 H 120 P 6 cod 6091. Mensole Ljos in alluminio laccato Quarzo, complete di accessori e retroilluminazione a LED. Rubinetteria Flow L02 cod 2555 e 2556 in acciaio PVD nero.

Puro W 220 composition composed of two finishing sides W 2 cod 9718, one washbasin base unit with drawer W 108 H 35.5 D 51 cod B8750 and a drawer base W 108 H 35.5 D 51 in Noce Canaletto cod 8757. Linear top W 220 cod 2952 and sit-on washbasin Keel 60 cod 2022 in Grafite marble. Ekos V wall-mounted mirror unit with all-round LED backlight, Quarzo finish lacquered aluminium profile W 54 H 120 D 6 cod 6091. Ljos shelves made of Quarzo finish lacquered aluminium, complete with accessories and LED backlight. Flow L02 tap cod 2555 and 2556 in black PVD steel.

Puro 24.03

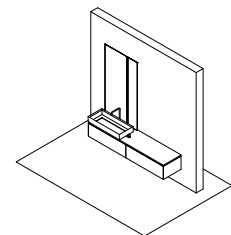

Composizione Puro L 220 composta da due fianchi di finitura L 2 cod 9718, una base lavabo con cassetto L 108 H 35,5 P 51 cod B8750 e una base cassetto L 108 H 35,5 P 51 in Pietra Medea cod 8757. Top integrato Height 02 in Pietra Medea L 220 cod 4652 con illuminazione LED. Specchiera Vetra con retroilluminazione a LED quattro lati, L 63 H 180 P 2,8 cod 2288 FM, L 24 H 180 P 2,8 cod

2286 FM. Rubinetteria Flow L08 cod 2559 e 2561 in acciaio lucido. Tappeto Plain 03 B cod 4107.

Puro W 220 composition composed of two finishing sides W 2 cod 9718, one washbasin base unit with drawer W 108 H 35.5 D 51 cod B8750 and a drawer base W 108 H 35.5 D 51 in Pietra Medea cod 8757. Height 02 integrated top in Medea stone W 220 cod 4652 with LED lighting. Vetra mirror unit with LED backlighting on four sides, W 63 H 180 D 2.8 cod 2288 FM, W 24 H 180 D 2.8 cod 2286 FM. Flow L08 tap cod 2559 and 2561 in polished steel. Plain 03 B carpet cod 4107.

Puro 24.04

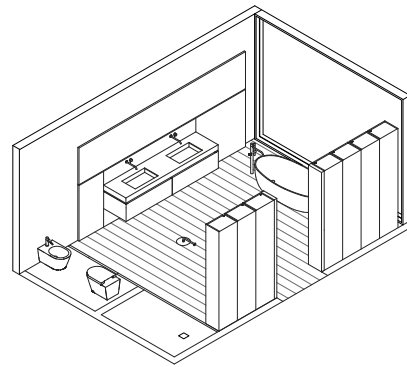

20,10 mq

Composizione Puro L 220 composta da due fianchi di finitura L 2 cod 9718, due basi lavabo L 108 H 35,5 P 51 cod B8750. Top integrato Next 04 L 220 H 12 con doppio lavabo cod 4965. Specchiere Vetra con retroilluminazione a LED 4 lati L 162/216 H 75 P 2,8 cod 2248 e 2251. Colonne a 45° in laccato Fango opaco L 45 H 210 P 32 cod 9049. Rubinetteria Flow L01 cod 2552 e 2553 in acciaio satinato. Sanitari Senna in ceramica bianca opaca cod 9311 e 9312, piletta up& down cod 9885. Rubinetteria Flow B01 cod 2569 e placca W01 acciaio satinato cod 2590. Vasca Oval in Cristalplant cod 9681. Rubinetteria Flow V01 cod 2586 e 2587 in acciaio satinato.

Puro W 220 composition composed of two finishing sides W 2 cod 9718, two washbasin base units W 108 H 35.5 D 51 cod B8750. Next 04 integrated top W 220 H 12 with double washbasin cod 4965. Vetra mirrors with 4-sided LED backlighting W 162/216 H 75 D 2.8 cod 2248 and 2251. 45° columns in matt Fango lacquered W 45 H 210 D 32 cod 9049. Flow L01 tap cod 2552 and 2553 in satin-finished steel. Senna sanitary ware in matt white ceramic cod 9311 and 9312, up&down

drain cod 9885. Flow B01 tap cod 2569 and W01 satin-finish steel plate cod 2590. Oval Cristalplant bathtub cod 9681. Flow V01 tap cod 2586 and 2587 in satin-finish steel.

Puro 24.05

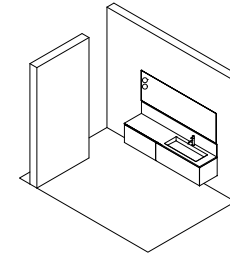

Composizione Puro L 220 composta da due fianchi di finitura L 2 cod 9719, una base cassetto L 90 H 46,1 P 51 cod 8794 con cassetto interno cod 2537 e una base lavabo con cassetto Rovere Termocotto L 126 H 46,1 P 51 cod 8783. Top integrato Next 05 in marmo Emperador L 220 cod 4650 con illuminazione a LED. Alzatina H 30 in marmo Emperador cod 2972. Specchiera Vetra con retroilluminazione a LED 4 lati H 75 L 220 P 2,8 cod 2251 FM. Lampade Moon a LED cod 2029. Portasciugamani Toro in Rovere Carbone cod 2448. Rubinetteria Flow L03 in acciaio satinato cod 2557. Tappeto Plain 02 W cod 4106.

Puro W 220 composition composed of two finishing sides W 2 cod 9719, one drawer base unit W 90 H 46.1 D 51 cod 8794 with internal drawer cod 2537 and a washbasin base unit with Rovere Termocotto drawer W 126 H 46.1 D 51 cod 8783. Next 05 integrated top in Emperador marble W 220 cod 4650 with LED lighting. Splashboard H 30 in Emperador marble cod 2972. Vetra mirror with 4-sided LED backlighting H 75 W 220 D 2.8 cod 2251 FM. Moon LED lamps cod 2029. Toro towel rack in Rovere Carbone cod 2448. Flow L03 satin-finish steel tap cod 2557. Plain 02 W carpet cod 4106.

Puro 24.06

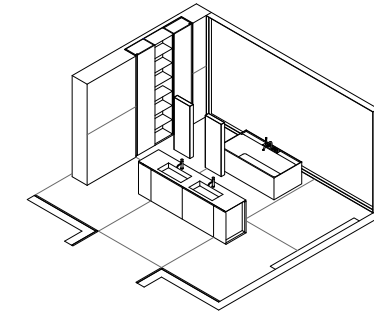

21,10 mq

Composizione Puro L 252 composta da due basi laterali centro stanza con anta in Noce Canaletto e fianco in vetro fumè L 36 H 81,2 P 56 cod 5394 e due basi lavabo con cassetto e cassetto interno in Noce Canaletto L 90 H 81,2 P 51 cod 8828. Schienali in finitura Sp 5 per basi centro stanza L 90 cod 2903. Zoccolo H 4 nero cod 2514. Top integrato Sand 02 L 252 P 56 MDi Totem Gris con doppio lavabo cod 5461. Specchiere Prisma L 45 H 150 P 13 cod 6500. Colonne a 45° in Noce Canaletto L 45 H 264 P 32 cod 9049 FM e vano a giorno con illuminazione a LED verticale L 45 H 264 P 32 cod 9238 FM. Rubinetteria Flute L03 acciaio satinato cod 5837, Flute V03 cod 5847. Vasca Creek in Milltek Solid cod 5660.

Puro W 252 composition composed of two side base units in the centre of the room with door in Noce Canaletto and side in smoked glass W 36 H 81.2 D 56 cod 5394 and two washbasin base units with drawer and internal drawer in Noce Canaletto W 90 H 81.2 D 51 cod 8828. Back panels in Th 5 finish for W 90 room centre units cod 2903. Plinth H 4 black cod 2514. Sand 02 integrated top W 252 D 56 MDi Totem Gris with double washbasin cod 5461. Prisma mirrors W 45 H 150 D 13 cod 6500. 45° Columns in Noce Canaletto W 45 H 264 D 32 cod 9049 FM and open unit with vertical LED lighting W 45 H 264 D 32 cod 9238 FM. Flute L03 satin-finish steel tap cod 5837, Flute V03 cod 5847. Creek bathtub in Milltek Solid cod 5660.

Puro 24.07

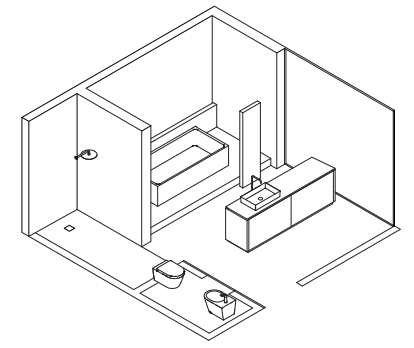

18,50 mq

Composizione Puro L 220 composta da due fianchi di finitura L 2 cod 9720, una base lavabo con cassetto e cassetto interno L 108 H 72 P 51 cod 8813 e una base con cassetto e cassetto interno in Rovere Termocotto L 108 H 72 P 51 cod 8824 e ulteriore cassetto interno cod 2538. Schienali in finitura Sp 5 per basi centro stanza L 108 cod 2828. Zoccolo H 4 nero cod 2514. Top lineare in Rovere Termocotto L 220 P 56 cod 2952 e lavabo Step 63.14 in Cristalplant cod 9297 con illuminazione a LED cod 9520. Specchiera Prisma L 45 H 150 P 13 cod 6500. Rubinetteria Flow L08 in acciaio lucido cod 2559 e 2561. Vasca ad incasso Styling R02_35 in Milltek solid cod 5669. Pedana per vasca H 17 in Rovere Termocotto cod 6465 e 6466. Rubinetteria Flow V03 cod 2585. Sanitari Senna in ceramica bianca opaca cod 9311 e 9312, piletta up& down cod 9885. Rubinetteria Flow B01 cod 2569 e placca W01 acciaio inox satinato cod 2590. Piatto doccia Sharp L 200 P 90 versione ad incasso in Ceramilux cod 9595. Soffione e braccio Flow D01 in acciaio satinato cod 2583 e 2584; miscelatore termostatico, deviatore e doccetta D03 cod 2574, 2571, e 2577, 2576.

Puro W 220 composition composed of two finishing sides W 2 cod 9720, a washbasin base unit with drawer and internal drawer W 108 H 72 D 51 cod 8813 and a base unit with drawer and internal drawer in Rovere Termocotto W 108 H 72 D 51 cod 8824 and additional internal drawer cod 2538. Back panels in Th 5 finish for W 108 room centre units cod 2828. Plinth H 4 black cod 2514. Linear top in Rovere Termocotto W 220 D 56 cod 2952 and Step 63.14 washbasin in Cristalplant cod 9297 with LED lighting cod 9520. Prisma Mirror W 45 H 150 D 13 cod 6500. Flow L08 tap cod 2559 and 2561 in polished steel. Styling R02_35 recessed bathtub in Milltek solid cod 5669. Footboard for bathtub H 17 in Rovere Termocotto cod 6465 and 6466. Flow V03 tap cod 2585.

Senna sanitary ware in matt white ceramic cod 9311 and 9312, up&down drain cod 9885. Flow B01 tap cod 2569 and W01 satin stainless steel flush plate cod 2590. Sharp shower tray W 200 D 90 recessed version in Ceramilux cod 9595. Flow D01 satin-finish steel shower head and arm cod 2583 and 2584; thermostatic mixer, diverter and hand shower D03 cod 2574, 2571, and 2577, 2576.

Puro 24.08

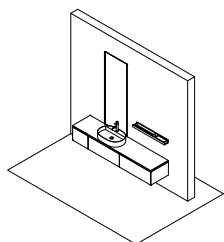

Composizione Puro L 229 composta da due fianchi di finitura L 2 cod 9718, una base con cassetto L 45 H 35,5 P 51 cod 8753, una base lavabo con cassetto L 90 H 35,5 P 51 cod B8749 e una base con cassetto L 90 H 35,5 P 51 cod 8756 in laccato Quarzo. Top lineare L 229 cod 2952 in laccato Quarzo e lavabo in appoggio Loop in Cristalplant cod 2023. Specchiera Vetra con retroilluminazione a LED 4 lati L 63 H 180 P 2,8 cod 2288 FM, lampada Linus verticale a LED cod 4205. Illuminazione a LED sotto le basi, cod 9645. Mensola Ljos in alluminio laccato Quarzo L 90 cod L01S. Rubinetteria Flow L03 in acciaio PVD nero cod 2557. Pouf Maki 2 in sughero nero cod 5068. Tappeto Lidi 03 B cod 4207.

Puro W 229 composition composed of two finishing sides W 2 cod 9718, one base unit with drawer W 45 H 35.5 D 51 cod 8753, one washbasin base unit with drawer W 90 H 35.5 D 51 cod B8749 and a base unit with drawer W 90 H 35.5 D 51 cod 8756 in Quartz finish lacquered. Linear top W 229 cod 2952 in Quartz finish lacquered and Loop sit-on washbasin in Cristalplant cod 2023. Vetra mirror with 4-sided LED backlighting W 63 H 180 D 2.8 cod 2288 FM, Linus vertical LED lamp cod 4205. LED lighting under the bases, cod 9645. Ljos shelf in Quartz finish lacquered aluminium W 90 cod L01S. Flow L03 black PVD steel tap cod 2557. Maki 2 pouf in black cork cod 5068. Lidi 03 B carpet cod 4207.

Puro 24.09

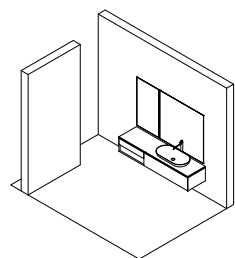

Composizione Puro L 202 composta da due fianchi di finitura L 2 cod 9718, una base con cassetto e vano a giorno con illuminazione a LED L 72 H 35,5 P 51 cod 8771 e una base lavabo con cassetto L 126 H 35,5 P 51 cod B8751 in Rovere Miele. Top lineare in Rovere Miele L 202 cod 2952 con illuminazione a LED. Lavabo in appoggio Blend 81 in Cristalplant cod 8888. Specchiere Vetra con retroilluminazione a LED 4 lati L 72 H 120 P 2,8 cod 2273 e L 126 H 120 P 2,8 cod 2279. Portasciugamani serie Toro in Rovere Carbone cod 2448. Rubinetteria Flow L04 in acciaio lucido cod 2558. Tappeto Plain 03 W cod 4107.

Puro W 202 composition composed of two finishing sides W 2 cod 9718, one base unit with drawer and open compartment with LED lighting W 72 H 35.5 D 51 cod 8771 and a washbasin base unit with drawer W 126 H 35.5 D 51 cod B8751 in Rovere Miele. Linear top in Rovere Miele W 202 cod 2952 with LED lighting. Blend 81 Cristalplant sit-on washbasin 8888. Vetra mirrors with 4-sided LED backlighting W 72 H 120 D 2.8 cod 2273 and W 126 H 120 P 2.8 cod 2279. Toro series towel racks in Rovere Carbone cod 2448. Flow L04 polished steel tap cod 2558. Plain 03 W carpet cod 4107.

Puro 24.10

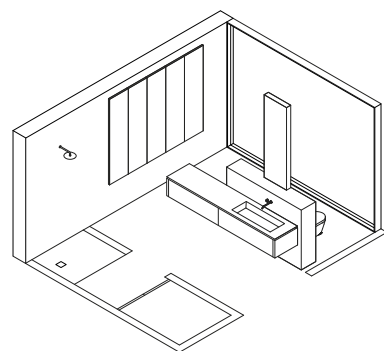

17,10 mq

Composizione Puro L 256 composta da due fianchi di finitura L 2 cod 9718, una base con cassetto L 126 H 35,5 P 51 cod 8758, una base lavabo con cassetto L 126 H 35,5 P 51 cod A8751 e un schienale in finitura SP 5 con LED per fissaggio alla parete di sostegno cod 2818 in Rovere Mezza Fiamma. Top integrato Next 03 in Corian L 256 P 56 cod 4650 con illuminazione a LED. Parete di sostegno L 180 H 125 P 35 in laccato Bianco opaco cod 1320. Specchiera Prisma L 54 H 150 P 13 cod 6501. Rubinetteria Flow L01 cod 2552 e 2553 in acciaio satinato. Sanitari Senna in ceramica bianca opaca cod 9311 e 9312, piletta up&down cod 9885. Rubinetteria Flow B01 cod 2569 e placca W01 acciaio inox satinato cod 2590. Colonne ad incasso L 45 H 180 P 23 in laccato bianco opaco cod 9019.

Puro W 256 composition composed of two L 2 finish sides cod 9718, one base unit with drawer W 126 H 35.5 D 51 cod 8758, one washbasin base unit with drawer W 126 H 35.5 D 51 cod A8751 and a back panel in TH 5 finish with LED for fixing to the supporting wall cod 2818 in Rovere Mezza Fiamma. Next 03 integrated top in Corian W 256 D 56 cod 4650 with LED lighting. Support wall W 180 H 125 D 35 in matt White finish lacquered cod 1320. Prisma Mirror W 54 H 150 D 13 cod 6501. Flow L01 tap cod 2552 and 2553 in satin-finished steel. Senna sanitary ware in matt white ceramic cod 9311 and 9312, up&down drain cod 9885. Flow B01 tap cod 2569 and W01 satin stainless steel flush plate cod 2590. Recessed columns W 45 H 180 D 23 in matt Bianco finish lacquered cod 9019.

Puro 24.11

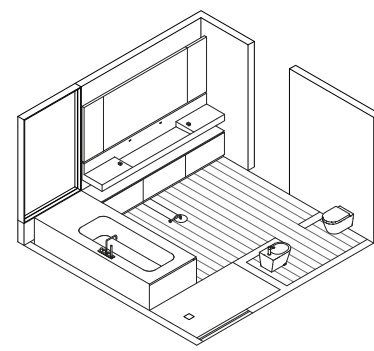

13,30 mq

Composizione Puro L 270 composta da tre basi con cassetto L 90 H 46,1 P 51 in laccato bianco opaco cod 8794. Top lineare in Milltek Solid L 270 e L 110 cod 2952. Zoccolo nero cod 2514. Vasca Styling R02 L 220 P 110 in Milltek Solid con pannellatura laccato Bianco opaco cod 5668, 5470 e 5471. Top sospeso Strict 06 in marmo bianco Arabescato cod 4791 con erogatori H2O cromo cod 9616. Miscelatori da piano Flow acciaio lucido cod 2559. Un fianco a specchio H 105 P 4,5 cod 2460, due specchiere contenitore semi-incasso L 54 H 105 P 4,5 cod 9133 con illuminazione a LED superiore ed inferiore, elemento fisso L 162 H 105 P 4,5 cod 9162 FM con illuminazione a LED superiore ed inferiore. Piatto doccia Sharp L 200 P 90 in Ceramilux cod 9595. Soffione e braccio Flow D01 in acciaio satinato cod 2583 e 2584; miscelatore termostatico, deviatore e doccetta D03 cod 2574, 2571, e 2577, 2576.

Puro W 270 composition comprising three base units with drawer W 90 H 46.1 D 51 in matt Bianco finish lacquered cod 8794. Linear top in Milltek Solid W 270 and W 110 cod 2952. Black footboard cod 2514. Styling R02 W 220 D 110 bathtub in Milltek Solid with matt Bianco lacquered panelling code 5668, 5470 e 5471. Wall-mounted Strict 06 top in Bianco Arabescato marble cod 4791 with chrome H2O spouts 9616. Flow countertop mixers polished steel cod 2559. One mirror side H 105 D 4,5 cod 2460, two semi-recessed mirror cabinets W 54 H 105 D 4,5 cod 9133 with top and bottom LED lighting, fixed element W 162 H 105 D 4,5 cod 9162 FM with top and bottom LED lighting. Sharp shower tray W 200 D 90 in Ceramilux cod 9595. Flow D01 satin-finish steel shower head and arm cod 2583 and 2584; thermostatic mixer, diverter and hand shower D03 cod 2574, 2571, and 2577, 2576.

Puro 24.12

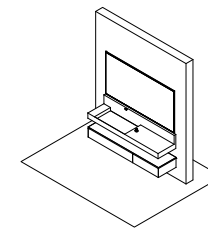

Composizione Puro L 202 composta da due fianchi di finitura L 2 cod 9717, una base con cassetto L 126 H 23,5 P 51 cod 8747 e una base L 72 H 23,5 P 51 cod 8744 in laccato Platino. Illuminazione a LED per basi al metro lineare L 198 cod 9645. Top lineare L 202 cod 2952 in laccato Platino. Top sospeso Strict 02 in Corian L 202 P 51 cod 4791 con erogatore H2O cromo cod 9616 e miscelatore da piano Flow acciaio lucido cod 2559. Specchiera Kara con retroilluminazione a LED 4 lati L 198 H 120 SP 3,5 cod 5242. Tappeto Plain 03 B cod 4107.

Puro W 202 composition composed of two finishing sides W 2 cod 9717, one base unit with drawer W 126 H 23.5 D 51 cod 8747 and a base W 72 H 23.5 D 51 cod 8744 in Platino finish lacquered. LED lighting for bases W 198 cod 9645. Linear top W 202 cod 2952 in Platino finish lacquered. Strict 02 wall-hung top in Corian W 202 D 51 cod 4791 with chrome H2O spout cod 9616 and Flow polished steel top-mounted mixer cod 2559. Kara mirror with 4-sided LED backlighting W 198 H 120 TH 3.5 cod 5242. Plain 03 B carpet cod 4107.

gola superiore
upper groove handle gorge

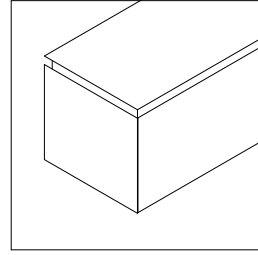

FINITURE FRONTALI E FIANCHI | FRONTS AND SIDES FINISHES



LACCATI OPACHI E LUCIDI | MATT AND GLOSSY LACQUERED
25 colori | colours



LACCATI METALLIZZATI | METALLIC LACQUERED
platino, zinco, quarzo, ambra, titanio, basalto



ESSENZE OPACHE | MATT VENEERS
ROVERE: mezza fiamma, barrique, nordico, miele, tundra, termocotto, carbone, nero; noce canaletto



MARMI OPACHI | MATT MARBLES
carrara, arabescato, siberia, grafite, petit granit, nero marquina

P 51 | D 20 1/8"

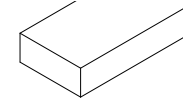

* solo con P 56 | only with D 22"

H 23,5 | 9 1/4"

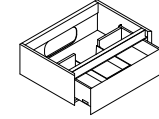

L | W
72 | 28 3/8"
90 | 35 3/8"
108 | 42 1/2"
126 | 49 5/8"

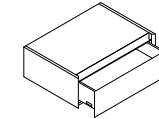

L | W
36 | 14 1/8"
45 | 17 3/4"
54 | 21 1/4"
72 | 28 3/8"
90 | 35 3/8"
108 | 42 1/2"
126 | 49 5/8"

H 35,5 | 14"

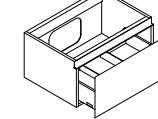

L | W
72 | 28 3/8"
90 | 35 3/8"
108 | 42 1/2"
126 | 49 5/8"

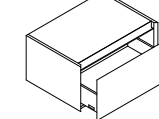

L | W
36 | 14 1/8"
45 | 17 3/4"
54 | 21 1/4"
72 | 28 3/8"
90 | 35 3/8"
108 | 42 1/2"
126 | 49 5/8"

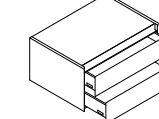

L | W
36 | 14 1/8"
45 | 17 3/4"
54 | 21 1/4"
72 | 28 3/8"
90 | 35 3/8"
108 | 42 1/2"
126 | 49 5/8"

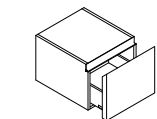

L | W
36 | 14 1/8"
45 | 17 3/4"

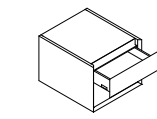

L | W
36 | 14 1/8"
45 | 17 3/4"
54 | 21 1/4"
72 | 28 3/8"
90 | 35 3/8"
108 | 42 1/2"
126 | 49 5/8"

H 46,1 | 18 1/8"

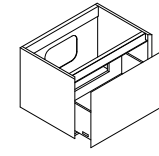

L | W
72 | 28 3/8"
90 | 35 3/8"
108 | 42 1/2"
126 | 49 5/8"

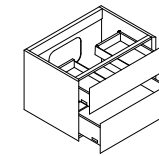

L | W
72 | 28 3/8"
90 | 35 3/8"
108 | 42 1/2"
126 | 49 5/8"

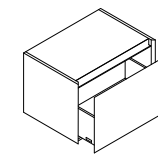

L | W
36 | 14 1/8"
45 | 17 3/4"
54 | 21 1/4"
72 | 28 3/8"
90 | 35 3/8"
108 | 42 1/2"
126 | 49 5/8"

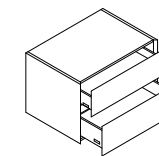

L | W
36 | 14 1/8"
45 | 17 3/4"
54 | 21 1/4"
72 | 28 3/8"
90 | 35 3/8"
108 | 42 1/2"
126 | 49 5/8"

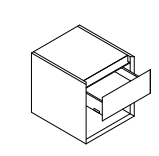

L | W
36 | 14 1/8"
45 | 17 3/4"
54 | 21 1/4"
72 | 28 3/8"
90 | 35 3/8"
108 | 42 1/2"
126 | 49 5/8"

H 72 | 28 3/8"

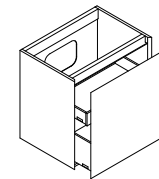

L | W
72 | 28 3/8"
90 | 35 3/8"
108 | 42 1/2"

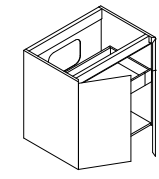

L | W
72 | 28 3/8"
90 | 35 3/8"

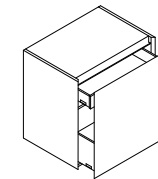

L | W
36 | 14 1/8"
45 | 17 3/4"
54 | 21 1/4"
72 | 28 3/8"
90 | 35 3/8"
108 | 42 1/2"

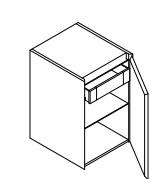

L | W
36 | 14 1/8"
45 | 17 3/4"

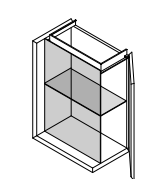

L | W
* 36 | 14 1/8"

H 81,2 | 32"

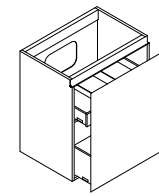

L | W
72 | 28 3/8"
90 | 35 3/8"
108 | 42 1/2"

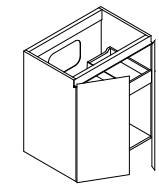

L | W
72 | 28 3/8"
90 | 35 3/8"

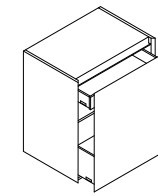

L | W
36 | 14 1/8"
45 | 17 3/4"
54 | 21 1/4"
72 | 28 3/8"
90 | 35 3/8"
108 | 42 1/2"

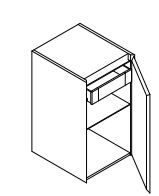

L | W
36 | 14 1/8"
45 | 17 3/4"

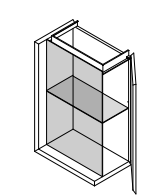

L | W
* 36 | 14 1/8"

art direction
Paolo Mojoli

graphic design
Juma

photos
Federico Cedrone
18–23, 32–35, 40–51

styling
Martina Bianchi
Juma

photo studio, set assistant
Ottonove

rendering
Nerokubo

prepress
Luce Group

printing
Grafiche Antiga

edition
January 2024

Milldue spa si riserva il diritto di apportare modifiche migliorative al prodotto in qualsiasi momento e senza preavviso. I campioni dei materiali sono a carattere puramente indicativo. | Milldue reserves the right to apply improving changes to the products at any time without prior notice. The samples are purely indicative.



thanks to

Amini carpets	Edizioni Design	Nahoor
Auerberg	Emil	Nasomatto
Bcxsy	Exit	Once Milano
Bolzan	Flos	Oscar Maschera
Brollo	FontanaArte	Raw
Bullfrog	Gabel	Restart Milano
Byredo	littala	Rimadesio
By Lassen	Incipit lab	Roberta Licini
C&C Milano	Ingrid Hulskamp	Scandola Marmi
Ceratina	Kristina Dam	Shuj
Cinelli	L:a Bruket	Skultuna
Colombo Design	La casa di Babette	Society Limonta
Couse de fil Blanc	Le Labo	Suede
Cuore Di Lino	Libeco	Tenoha Milano
Davide Aquini	Living Divani	Toscanini
Dep Design Store	Madame Gioia	Womo

noorth

marchio registrato | registred trademark

MILLDUE SPA
sede legale: via Balegante 7, 31039 Riese Pio X, Treviso, Italy
sede operativa: via dell'Economia 6, 31033 Castelfranco Veneto, Treviso, Italy
P. I. 00544260268, tel +39 0423 756611, fax +39 0423 756699, noorth@milldue.it, www.noorth.it

